

SPECIFICATII PENTRU DIN 316 , SURUB FLUTURE

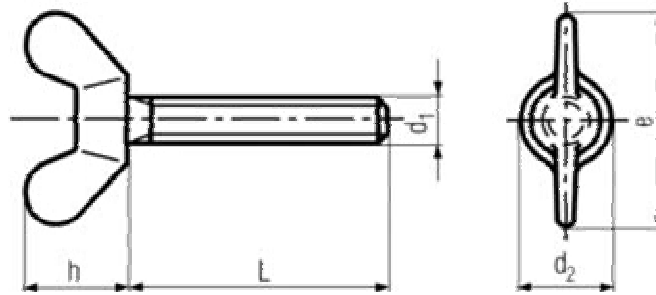

**ROCAST**

\*Toate masuratorile sunt in milimetri (mm)\*

d	h	e	d <sub>2</sub>
M4	8.5	18	6
M5	11	24	8
M6	15	30	10
M8	18	36	13
M10	23	48	17
M12	31	62	20
M16	35	70	26